

Location map



The Developer :
Swastik Builders

Office : Swastik Sales, Tilak Nagar, Baddia Kalan, Bhopal (M.P.)
 Site : Custom Colony, Kolar Road, Bhopal (M.P.),
 e-mail : swastikbuildersbhopal@gmail.com

Project by :

Grandridge HOMES

Eminence of Life
 MM-27, C block, Mansarover Complex,
 Opp. Habibganj Railway Station, Bhopal (M.P.),
 e-mail : grandridge@in.com

The Architect :
ABODE DESIGN
 M.P. Nagar, Bhopal

Contact for Booking / Enquiry : +91 - 9826861959, 9713137590



At Custom Colony, Kolar Road, Bhopal

Forever
 is composed of now !



Homes... Truly Timeless

Time demands change. And with this changing time change the choices, trends and likings. But, the thing that never loses its allure despite the change in time is called truly timeless.

By keeping this fact in mind, we have built some homes at Swastik Apartment, not only for you, also for the generations to come.



Project Highlights



- Vastu Oriented Planning & Design.
- Separate Visitors Lobby.
- 24 x 7 Security arrangement.
- Ample Parking Space.
- Kid's Play Zone.
- Lift Facility.
- Terrace Garden.
- Open community space for social gatherings.
- Rain Water Harvesting.
- 24 x 7 water supply.
- Ample Light & Ventilation



Super builtup Area
850 Sq. Ft.

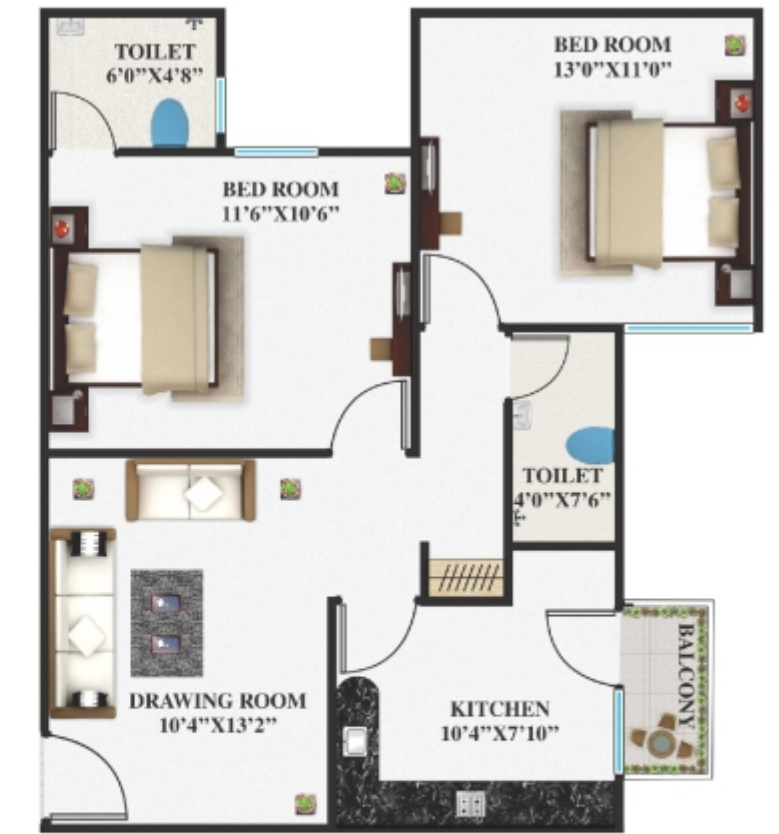

Super builtup Area
930 Sq. Ft.



**Super builtup Area
960 Sq. Ft.**



**Super builtup Area
750 Sq. Ft.**





S.B.U. Area 930 Sq. Ft.

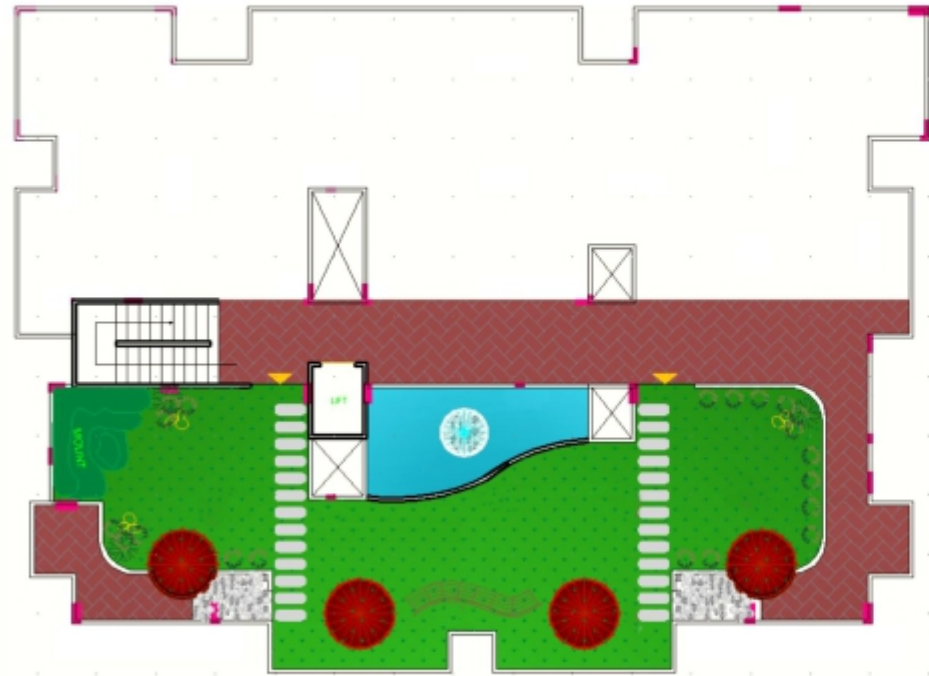
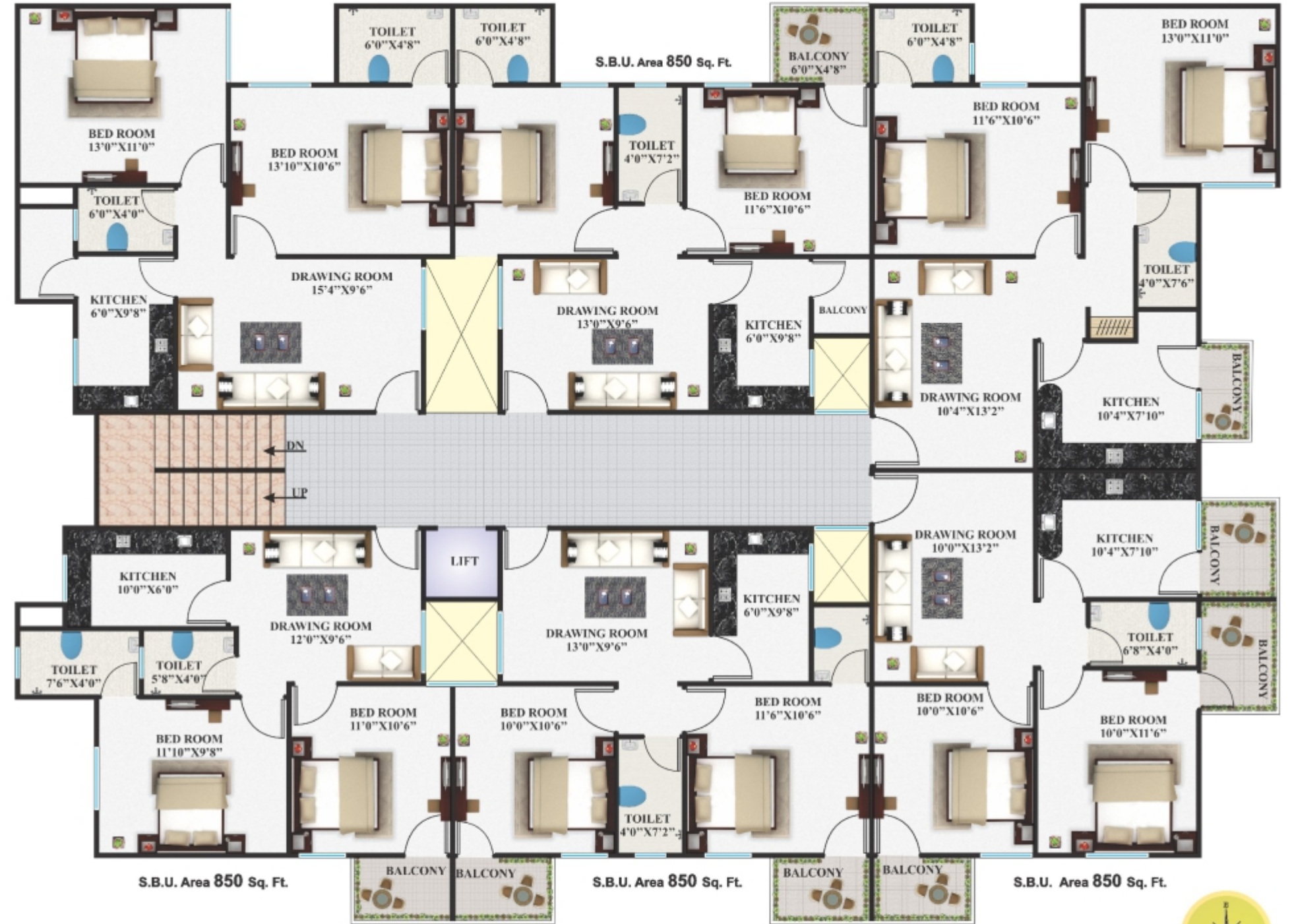

Specifications :-

- | | | | |
|--------------------|---|--------------------------|--|
| Structure : | R.C.C. Framed structure, designed for earthquake safety. | Openings : | Doors - pressed steel section frames and good quality flush door. Windows - Powder coated aluminum section with glazed shutters. |
| Walls : | First class brick masonry with 8" width common wall and 4" width partition wall with smooth finish plaster on both external and internal walls. | Water Supply : | Water supply through sump well and individual overhead tank of 750 ltr. |
| Flooring : | Good quality vitrified tiles for all rooms and anti skid tiles for wash area and toilets. | Electrification : | Concealed copper wiring, sufficient light points with branded switches, T.V. pointing in living, Telephone point in living and provision for inverter. |
| Toilet : | Designer tiles upto 7' ht. Chrome plated good quality fittings with hot and cold water mixer. Louver ventilator for toilets. | Painting : | Internal - Putty finish wall with oil bond distemper, External - Cement based weather resistant paint. |
| Kitchen : | Green Marble top kitchen with stainless steel sink, glazed tiles dado upto 2'ht. above platform, provision for exhaust fan and water purifier. | Staircase : | Marble Steps. MS Steel Railing. |
| | | POP : | Ceilings to have decorative POP cornice in living & dining. |